



# NIAGARA

**General Catalogue  
Catálogo General  
Catalogue général**



## NIAGARA

FUTURE INTELLIGENT PUMPS



**North America:**

**Head Office, Canada:**

- 📍 Address: 4 Laurier Ave, Milton, Postal Code: L9T4V2, Ontario, Canada.
- ☎️ Tel: +1 (514) 550 5578
- ✉️ Email: sales@niagarapumps.ca

**USA:**

- 📍 Address: 8450 Cambridge street zip code 77054 Houston Texas.
- ☎️ Tel: +1 (713) 363 1585
- ✉️ Email: usa@niagarapumps.ca



**Europe:**

**Sweden:**

- 📍 Address: Lisa sass Gatan 12 Gothenburg – Sweden.
- ☎️ Tel: +4 (670) 099 1626
- ✉️ Email: sweden@niagarapumps.ca

**Turkey:**

- 📍 Address: FATIH MAH URFALILAR CAD, NO 9A, Esenyurt, Istanbul-Turkey.
- ☎️ Tel: +9 (537) 523 9069
- ✉️ Email: turkey@niagarapumps.ca



**Middle East:**

- 📍 Address: Liwara 1, Shaikh Rashid Bin Humaid St. Ajman, UAE
- ☎️ Tel: +9 (715) 5269 3552
- ✉️ Email: uae@niagarapumps.ca

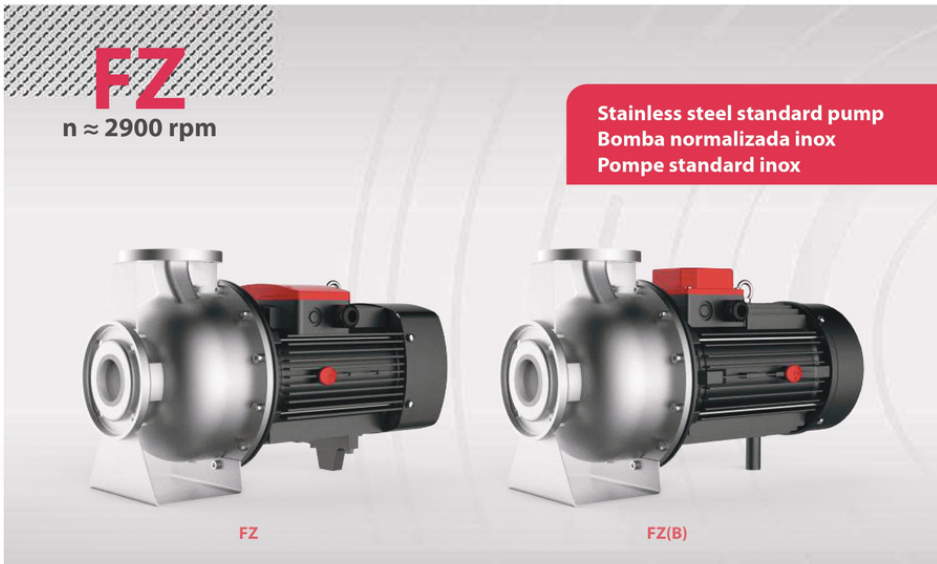

TECHNICAL DATA/DATOS TÉCNICOS/DONNÉES TECHNIQUES

n=2900 l/min

MODEL MODELO MODÈLE	DN mm	Power Potencia Puissance kw hp	Q=DELIVERY/CAUDAL/DÉBIT																									
			m³/h 0 9 12 18 20 24 36 42 54 72 114 126 132 138 150 204 216 228 240																									
			H=Head/Altura/Hauteur(m)																									
FZ 32-160/11	50x32	1.1 1.5	22.5	19.9	18.4	14.1	12	-	-	-	-	-	-	-	-	-	-	-	-	-	-	-	-	-	-	-	-	-
FZ 32-160/15	50x32	1.5 2	29.5	26.5	24.5	19.2	17	-	-	-	-	-	-	-	-	-	-	-	-	-	-	-	-	-	-	-	-	-
FZ 32-160/22	50x32	2.2 3	37	34	32	27	25	-	-	-	-	-	-	-	-	-	-	-	-	-	-	-	-	-	-	-	-	-
FZ 32-200/30	50x32	3 4	44	40	37.5	31	28	-	-	-	-	-	-	-	-	-	-	-	-	-	-	-	-	-	-	-	-	-
FZ 32-200/40	50x32	4 5.5	55	52	49.5	43.5	40.5	37	-	-	-	-	-	-	-	-	-	-	-	-	-	-	-	-	-	-	-	-
FZ 32-200/55	50x32	5.5 7.5	70.5	67.5	65	58.5	55	51	-	-	-	-	-	-	-	-	-	-	-	-	-	-	-	-	-	-	-	-
FZ 40-125/15	65x40	1.5 2	20	-	19	17.6	17	15.7	10.3	7	-	-	-	-	-	-	-	-	-	-	-	-	-	-	-	-	-	-
FZ 40-125/22	65x40	2.2 3	26.5	-	25.5	24	23.5	22	16.4	13	-	-	-	-	-	-	-	-	-	-	-	-	-	-	-	-	-	-
FZ 40-160/30	65x40	3 4	31	-	29.5	27.5	27	25.5	20	17	-	-	-	-	-	-	-	-	-	-	-	-	-	-	-	-	-	-
FZ 40-160/40	65x40	4 5.5	40	-	38.5	37	36	34.5	29	25.5	-	-	-	-	-	-	-	-	-	-	-	-	-	-	-	-	-	-
FZ 40-200/55	65x40	5.5 7.5	47	-	45.5	44	43	41	35	31	-	-	-	-	-	-	-	-	-	-	-	-	-	-	-	-	-	-
FZ 40-200/75	65x40	7.5 10	58	-	57	55.5	55	53.5	47.5	44	-	-	-	-	-	-	-	-	-	-	-	-	-	-	-	-	-	-
FZ 40-200/110	65x40	11 15	72	-	71	70	70	68.5	63	59	-	-	-	-	-	-	-	-	-	-	-	-	-	-	-	-	-	-
FZ 50-125/22	65x50	2.2 3	19	-	-	-	-	17.5	14.9	13.4	10.7	-	-	-	-	-	-	-	-	-	-	-	-	-	-	-	-	-
FZ 50-125/30	65x50	3 4	22	-	-	-	-	20.5	18.4	17	14.4	8	-	-	-	-	-	-	-	-	-	-	-	-	-	-	-	-
FZ 50-125/40	65x50	4 5.5	26.5	-	-	-	-	26	24	22.5	20.5	14	-	-	-	-	-	-	-	-	-	-	-	-	-	-	-	-
FZ 50-160/55	65x50	5.5 7.5	33	-	-	-	-	31	28.5	27	24.5	18	-	-	-	-	-	-	-	-	-	-	-	-	-	-	-	-
FZ 50-160/75	65x50	7.5 10	40	-	-	-	-	38.5	36	35	32.5	26	-	-	-	-	-	-	-	-	-	-	-	-	-	-	-	-
FZ 50-200/92	65x50	9.2 12.5	53	-	-	-	-	49	47.5	44.5	34	-	-	-	-	-	-	-	-	-	-	-	-	-	-	-	-	-
FZ 50-200/110	65x50	11 15	59	-	-	-	-	55	54	51	42	-	-	-	-	-	-	-	-	-	-	-	-	-	-	-	-	-
FZ 50-200/150	65x50	15 20	72	-	-	-	-	69	68	65	57	-	-	-	-	-	-	-	-	-	-	-	-	-	-	-	-	-
FZ 65-125/40	80x65	4 5.5	22.2	-	-	-	-	19.8	19	17.3	13.5	6.3	-	-	-	-	-	-	-	-	-	-	-	-	-	-	-	-
FZ 65-125/55	80x65	5.5 7.5	27	-	-	-	-	24	22.2	18.5	10.8	8	-	-	-	-	-	-	-	-	-	-	-	-	-	-	-	-
FZ 65-125/75	80x65	7.5 10	32	-	-	-	-	29.5	27.8	24	16.1	13.4	12	-	-	-	-	-	-	-	-	-	-	-	-	-	-	-
FZ 65-160/92	80x65	9.2 12.5	36.5	-	-	-	-	34.5	32.8	29	21.1	18.3	16.8	-	-	-	-	-	-	-	-	-	-	-	-	-	-	-
FZ 65-160/110	80x65	11 15	40.5	-	-	-	-	38.5	37.1	33.5	25.8	23	21.5	20	-	-	-	-	-	-	-	-	-	-	-	-	-	-
FZ 65-160/150	80x65	15 20	48	-	-	-	-	45.5	44	40.5	32.6	29.6	28	26.5	-	-	-	-	-	-	-	-	-	-	-	-	-	-
FZ 65-200/150	80x65	15 20	53.5	-	-	-	-	51	49	44.5	35.3	31.8	30	-	-	-	-	-	-	-	-	-	-	-	-	-	-	-
FZ 65-200/185	80x65	18.5 25	60.5	-	-	-	-	58.5	56.5	52	43	39.7	38	36.3	-	-	-	-	-	-	-	-	-	-	-	-	-	-
FZ 65-200/220	80x65	22 30	67	-	-	-	-	65.5	64	60	51	48	46.5	45	-	-	-	-	-	-	-	-	-	-	-	-	-	-
FZ 80-160/110	100x80	11 15	29	-	-	-	-	-	-	-	27.5	24.2	23	22.4	21.8	20.4	12.5	-	-	-	-	-	-	-	-	-	-	-
FZ 80-160/150	100x80	15 20	35	-	-	-	-	-	-	-	34.5	31.5	30.5	30	29.4	28.1	21	19.1	17	-	-	-	-	-	-	-	-	-
FZ 80-160/185	100x80	18.5 25	40	-	-	-	-	-	-	-	39.5	36.7	35.7	35.2	34.7	33.5	26.4	24.4	22.3	20	-	-	-	-	-	-	-	-
FZ 80-200/220	100x80	22 30	50	-	-	-	-	-	-	-	48.5	44.5	43	42	41	39	27.8	25	-	-	-	-	-	-	-	-	-	-
FZ 80-200/300	100x80	30 40	60	-	-	-	-	-	-	-	59	56	54.5	54	53	51	41.5	39	36.1	33	-	-	-	-	-	-	-	-
FZ 80-200/370	100x80	37 50	66	-	-	-	-	-	-	-	64	61	59.5	59	58	56.5	47	44.5	41.5	38.5	-	-	-	-	-	-	-	-

DESCRIPTION/DESCRIPCIONES/DESCRIPTION

- Stainless steel 304 standard pump design
- All wetted parts are in stainless steel 304
- Both square motor & round motor available
- Stainless steel AISI 316 material as request
- Back pull-out design without removing the pipes
- Quality bearing, wear resistance mechanical seal
- Available to delivery some impure liquid

- Diseño de bomba estándar de acero inoxidable 304
- Todas las partes húmedas son de acero inoxidable 304.
- Motor cuadrado y motor redondo disponibles.
- Material de acero inoxidable 316 según pedido
- Diseño de extracción posterior sin quitar las tuberías
- Rodamiento de calidad y cierre mecánico personalizado
- Disponible para la entrega de algún líquido impuro

USING LIMITS/LÍMITES UTILIZACIÓN/UTILISATION LIMITES

- Liquid temperature between -10°C and +120°C
- Ambient temperature between 0°C and +50°C
- Max. working pressure 16 bar/Continuous S1

MODEL CODE/CÓDIGO MODELO/CODE MODÈLE

For example/ Por ejemplo/ Par exemple

**FZ (m) 40 - 200 / 75**

- 75=Rated power(kw)x10  
Potencia nominal (kw)x10  
Puissance nominale (kw) x10
- 200=Nominal impeller size(mm)  
Tamaño nominal del impulsor (mm)  
Taille nominale de la roue (mm)
- 40=Discharge size(mm)  
Tamaño de descarga (mm)  
Taille de décharge (mm)
- m=Single phase/Monofásico/Monophasé  
Blank=Three phase  
Blanco=Trifásico  
Blanc=Triphasé
- FZ=Stainless steel standard pump  
Bomba normalizada en acero inoxidable  
Pompe standard en acier inoxydable

PERFORMANCE CURVE/CURVA DE RENDIMIENTO/COURBE DE PERFORMANCE

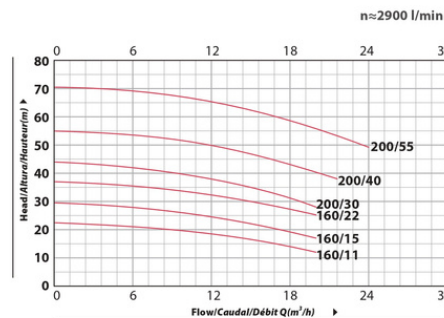

FZ 32

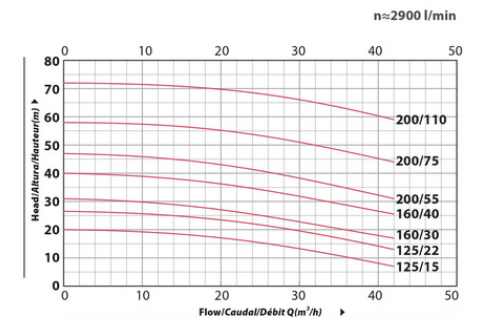

FZ 40

# FZ

PERFORMANCE CURVE/CURVA DE RENDIMIENTO/COURBE DE PERFORMANCE

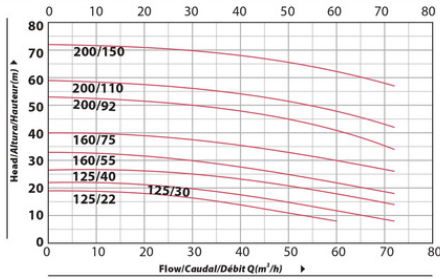

FZ 50

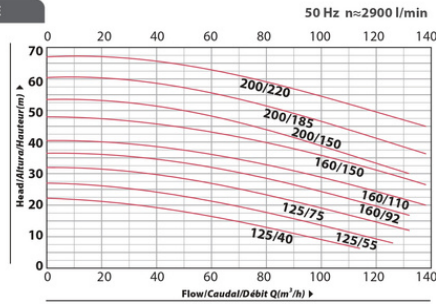

FZ 65

MATERIAL DESCRIPTION/DESCRIPCIÓN DE MATERIAL/DESCRIPTION DU MATÉRIEL

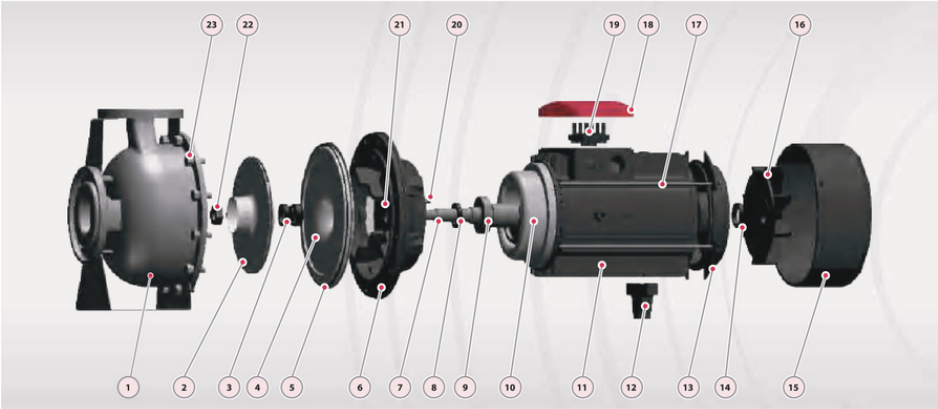

No.	Description Descripción Description	Material Material Matériel	No.	Description Descripción Description	Material Material Matériel	No.	Description Descripción Description	Material Material Matériel
1	Pump Case Cuerpo de Bomba Boîtier de pompe	SS304 Inox 304 Inox 304	9	Bearing Rodamiento Palier	Ball Bearing Bola Rodamiento Palier Balle	17	Through Bolt Perno Boulon	Steel Acero Acier
2	Impeller Impulsor Roue	SS304 Inox 304 Inox 304	10	Wound Stator/Rotor Estator/Rotor Stator/Rotor	Silicon/Copper Silicio/Cobre Silicium/Cuivre	18	Terminal Box Caja Bornas Boîte Bornes	Aluminum Aluminio Aluminium
3	Mechanical Seal Cierre Mecánico Sceller	SiC/Carbon/SS304 SiC/Grafito/Inox304 SiC/Carbon/Inox304	11	Motor Case Cuerpo Motor Boîtier Moteur	Aluminum Aluminio Aluminium	19	Terminal Board Tablero Bornas Bornier	Plastic Plástico Plastique
4	Baffle plate Placa de baffle Plaque chicane	SS304 Inox 304 Inox 304	12	Support Foot Soporte Pie Pied support	Plastic Plástico Plastique	20	Impeller Key Chaveta Clé	Iron Hierro Le fer
5	O-ring Junta Tórica Joint Torique	Rubber Caucho Caoutchouc	13	Back Cover Tapa Trasera Capot Arrière	Cast iron Fundición Fonte	21	Water Deflector Deflector Déflecteur	Rubber Caucho Caoutchouc
6	Connection Conexión Lien	Cast iron Fundición Fonte	14	Reinforced Seal Sello Reforzado Sceller	Rubber Caucho Caoutchouc	22	Impeller Nut Nuez Noix	Galvanized Steel Acero Galvanizado Acier Galvanisé
7	Shaft Eje Arbre	SS304 Inox 304 Inox 304	15	Fan Cover Tapa Capot	Aluminum Aluminio Aluminium	23	Connection Bolt Perno Boulon de connexion	Steel Acero Acier
8	Reinforced Seal Sello Reforzado Sceller	Rubber Caucho Caoutchouc	16	Fan Ventilador Ventilateur	Plastic Plástico Plastique			



# NIAGARA

PERFORMANCE CURVE/CURVA DE RENDIMIENTO/COURBE DE PERFORMANCE

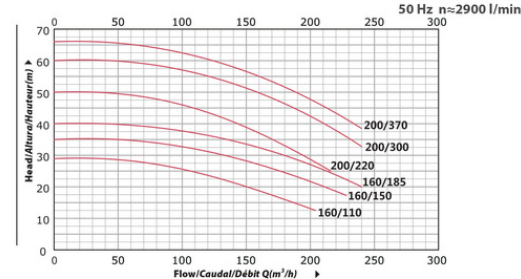

FZ 80

DIMENSIONS AND N.W./DIMENSIONES Y PESOS/DIMENSIONS ET POIDS

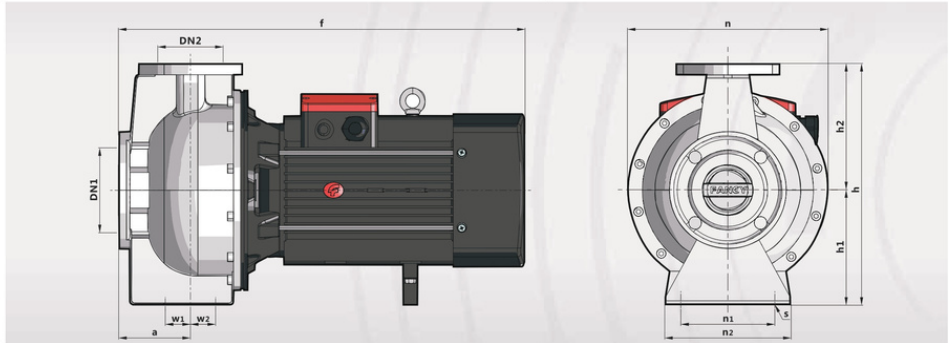

MODEL/MODELO/MODÈLE		DIMENSIONS/DIMENSIONES/DIMENSIONS mm													kg	
Single-phase Monofásico Monophasé	Three-phase Trifásico Triphasé	DN1	DN2	a	f	h	h1	h2	n	n1	n2	w1	w2	s	1-	3-
32-160/11-15	32-160/11-15	50	32	100	493	306	150	156	235	148	175	60	31	15	20.6/23.5	19.6/22.5
32-160/22	32-160/22	50	32	100	493	306	150	156	235	148	175	60	31	15	25.6	24.6
32-200/30	32-200/30-40	50	32	100	538	306	150	156	235	148	175	60	31	15	33.8	32.8/39.5
-	32-200/55	50	32	100	538	306	150	156	235	148	175	60	31	15	-	48.5
40-125/15-22	40-125/15-22	65	40	100	493	306	150	156	235	148	175	60	31	15	21.1/23.7	20.1/22.7
40-160/30	40-160/30-40	65	40	105	542	340	160	180	278	148	175	60	31	15	29	28/35.1
-	40-200/55-75	65	40	105	584	340	160	180	278	148	175	60	31	15	-	48.8/56.2
-	40-200/110	65	40	105	650	340	160	180	235	148	175	60	31	15	-	67.5
50-125/22	50-125/22	65	50	100	428	340	160	180	235	148	175	60	31	15	29.1	28.1
50-125/30	50-125/30-40	65	50	100	493	340	160	180	278	148	175	60	31	15	29.6	28.6/35.2
-	50-160/55-75	65	50	105	584	340	160	180	278	148	175	60	31	15	-	49.1/55.5
-	50-200/92-110	65	50	105	650	365	185	180	278	148	175	60	31	15	-	61.7/67.5
-	50-200/150	65	50	105	768	365	185	180	278	148	175	60	31	15	-	96
-	65-125/40	80	65	100	584	340	160	180	278	148	175	60	31	15	-	40
-	65-125/55-75	80	65	100	584	340	160	180	278	148	175	60	31	15	-	52/58.5
-	65-160/92-110	80	65	113	675	345	160	185	278	148	175	60	31	15	-	67/75.6
-	65-160/150	80	65	113	732	345	160	185	278	148	175	60	31	15	-	93
-	65-200/150-185	80	65	113	793	370	185	185	278	148	175	60	31	15	-	114/127
-	65-200/220	80	65	113	793	370	185	185	278	148	175	60	31	15	-	136
-	80-160/110	100	80	125	700	400	180	220	278	148	175	60	31	15	-	85
-	80-160/150-185	100	80	125	870	400	180	220	278	148	175	60	31	15	-	119/135
-	80-200/220	100	80	125	915	450	200	250	278	148	175	60	31	15	-	185
-	80-200/300-370	100	80	125	985	450	200	250	278	148	175	60	31	15	-	265/285

Back pull-out design  
Diseño extraíble hacia atrás  
Conception arrière coulissante

It allows removal of the motor, the coupling, the cantilever support and the impeller without compromising the housing of the pump body or removing the pipes.

Permite retirar el motor, el acoplamiento, el soporte en voladizo y el impulsor sin comprometer la carcasa del cuerpo de la bomba ni quitar las tuberías.

Il permet le démontage du moteur, de l'accouplement, du support en porte-à-faux et de la roue sans compromettre le logement du corps de pompe ou retirer les tuyaux.

